

# Soils Map

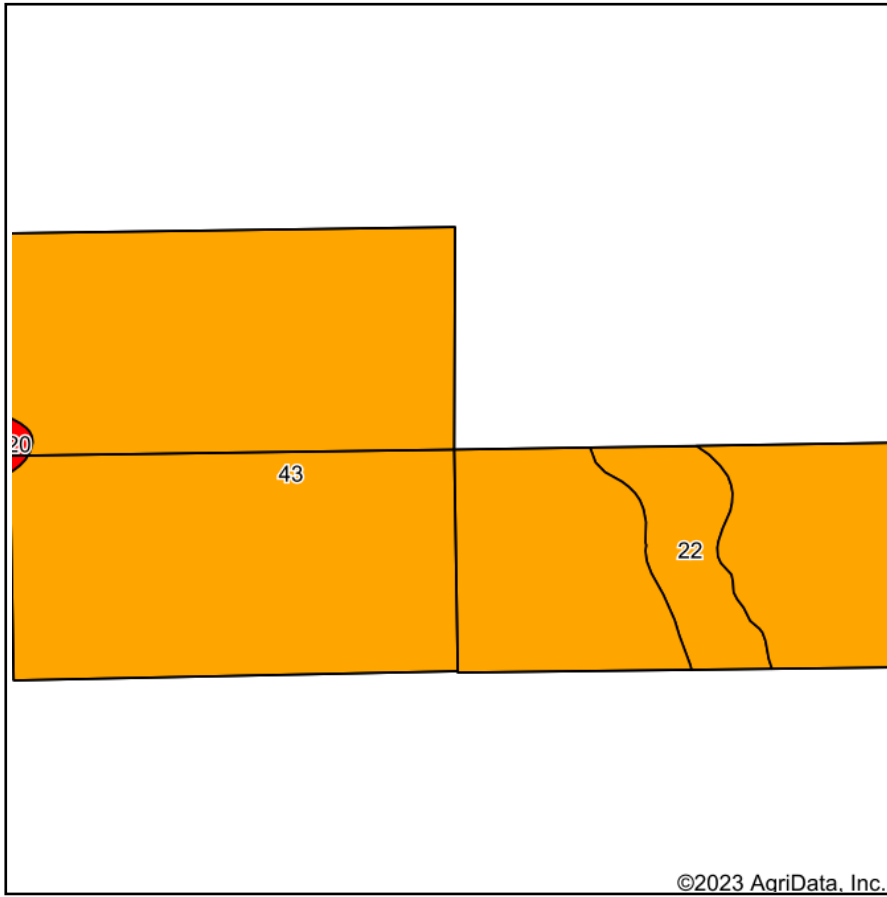

Soils data provided by USDA and NRCS.

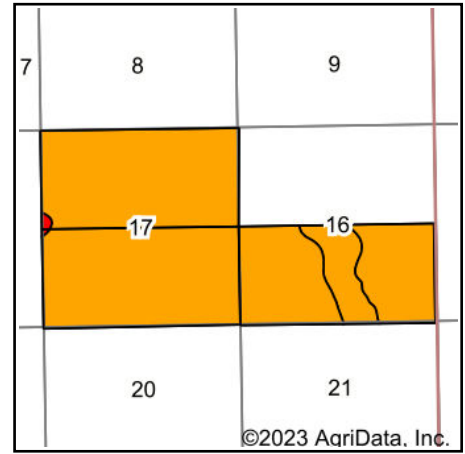

State: **Colorado**  
 County: **Kiowa**  
 Location: **17-20S-54W**  
 Township: **Haswell**  
 Acres: **962.51**  
 Date: **4/10/2023**



Maps Provided By:



Area Symbol: CO061, Soil Area Version: 20

Code	Soil Description	Acres	Percent of field	Non-Irr Class Legend	Non-Irr Class *c	Irr Class *c	Grain sorghum Bu
43	Olney sandy loam, 0 to 3 percent slopes	897.61	93.3%		IVc	IIIe	
22	Kim-Stoneham-Larimer loams, 3 to 12 percent slopes	62.06	6.4%		IVe	IVe	15
20	Kim-Harvey loams, 1 to 3 percent slopes	2.84	0.3%		VIe	Ile	13
<b>Weighted Average</b>					<b>4.01</b>	<b>3.06</b>	<b>1</b>

\*c: Using Capabilities Class Dominant Condition Aggregation Method  
 Soils data provided by USDA and NRCS.